

# NORWEGIAN GEM ACCOMMODATIONS

## THE HAVEN BY NORWEGIAN®

Located at the top of the ship, The Haven features private keycard access, a 24-hour butler, concierge service, a private courtyard, private restaurant and bar. All Suites offer luxury baths and private balconies.

### H1 THE HAVEN 3-BEDROOM GARDEN VILLA

Sleeps up to eight. Featuring three separate bedrooms, each with a king- or queen-size bed, luxury bath, living room, dining room and private garden with hot tub. Access to the private courtyard area. Includes butler and concierge service.

### H2 THE HAVEN DELUXE OWNER'S SUITE WITH LARGE BALCONY



Sleeps up to four. Featuring a living room, dining room, wall of windows with a king-size bed, luxury bath and a large balcony with an amazing view. Access to the private courtyard area. Includes butler and concierge service.

### H3 THE HAVEN DELUXE OWNER'S SUITE WITH BALCONY

Sleeps up to four. Featuring a separate bedroom, a king-size bed and luxury bath with separate shower, living room, dining room and private balconies.

### H4 THE HAVEN OWNER'S SUITE WITH LARGE BALCONY

Sleeps up to four. Featuring a separate bedroom with king-size bed, luxury bath with separate shower, guest bath, living and dining area and two large balconies. Access to The Haven. Includes concierge and 24-hour butler service.

### H6 THE HAVEN 2-BEDROOM FAMILY VILLA WITH BALCONY

Sleeps up to six. Featuring one bedroom with a queen-size bed, luxury bath and shower, separate children's bedroom, living area, dining area and private balcony. Access to the private courtyard area. Includes butler and concierge service.

### HF THE HAVEN COURTYARD PENTHOUSE WITH BALCONY

Sleeps up to three. Featuring one bedroom with a queen-size bed, luxury bath and shower, extra bedding for additional guest, living area, dining area and private balcony. Access to private courtyard area. Includes butler and concierge service.

## SUITES

All Suites feature a king- or queen-size bed, luxury baths, private balconies and butler and concierge service.

### S4 2-BEDROOM DELUXE FAMILY SUITE WITH BALCONY

Sleeps up to six. Featuring a bedroom with a queen-size bed, a separate children's bedroom, living area, dining area, private balcony and luxury bath with separate shower. Includes butler and concierge service. Can connect to a Club Balcony Suite.

### SD FORWARD-FACING DELUXE PENTHOUSE WITH LARGE BALCONY

Sleeps up to four. Featuring one bedroom with a queen-size bed and luxury bath and shower, living area, dining area and large, private balcony with an amazing view. Includes butler and concierge service.

### SF FORWARD-FACING PENTHOUSE WITH LARGE BALCONY

Sleeps up to three. Featuring a large, forward-facing balcony, queen-size bed, luxury bath with separate bathtub, living area, dining area and a single sofa bed. Includes butler and concierge service.

### SM AFT-FACING PENTHOUSE WITH LARGE BALCONY

Sleeps up to three. Featuring one bedroom with a queen-size bed and luxury bath and shower, living area, dining area and large, private balcony. Includes butler and concierge service.

### SN AFT-FACING PENTHOUSE WITH BALCONY

Sleeps up to three. Featuring one queen-size bed or two lower beds that convert to a queen, a single sofa bed, luxury bath, shower and balcony. Some feature living and dining rooms. Includes concierge and butler service in most.

## CLUB BALCONY SUITES AND BALCONY STATEROOMS

Club Balcony Suites offer a little more space than Balcony staterooms. All staterooms feature two lower beds that convert to a queen-size bed.

### M1 AFT-FACING CLUB BALCONY SUITE

Sleeps up to four. They have two lower beds that convert into a queen-size bed as well as a sitting area, luxury bath with shower and additional bedding to sleep two additional guests. Because they are aft-facing, the view from your private balcony is truly amazing.

### MA MB CLUB BALCONY SUITE\*

Sleeps up to four. Featuring two lower beds that convert into a queen-size bed, extra bedding to sleep two additional guests, a sitting area, luxury bath with shower and a private balcony.

### B1 AFT-FACING BALCONY

Sleeps up to four. The two lower beds can be converted to a queen-size bed, and the convertible sofa pulls out to sleep two more. You'll also have a sitting area and floor-to-ceiling glass doors that open to a private balcony.

### B4 FAMILY BALCONY

Sleeps up to four. Featuring two lower beds that convert to a queen-size bed, one pullman and one single sofa bed. Also includes a sitting area and floor-to-ceiling glass doors that open to a private balcony.

### BA BF BALCONY\*

Sleeps up to four. Featuring two lower beds that convert into a queen-size bed, with extra bedding for two additional guests. Includes a sitting area and floor-to-ceiling glass doors that open to a private balcony.

### BT SOLO BALCONY

These spacious staterooms include a queen-size bed, sitting area and floor-to-ceiling glass doors that open onto a private balcony. Staterooms are priced exclusively for solo travelers.

## OCEANVIEW AND INSIDE STATEROOMS

All feature two lower beds that convert to a queen-size bed.

### O4 FAMILY OCEANVIEW

Sleeps up to four. Featuring two lower beds that convert into a queen-size bed, extra bedding for two additional guests and a big picture window. Includes room service and many other amenities.

### OA OB OCEANVIEW WITH PICTURE WINDOW\*

Sleeps up to three. Features two lower beds that convert into a queen-size bed, extra bedding for an additional guest and a big picture window. Includes room service and many more amenities.

### OF OCEANVIEW

Sleeps up to four. Featuring two lower beds that convert into a queen-size bed, extra bedding for two additional guests and a porthole to enjoy the view.

### OT SOLO OCEANVIEW

These staterooms feature a large round window and a queen-size bed. Staterooms are priced exclusively for solo travelers.

### OK OBSTRUCTED OCEANVIEW

Sleeps up to four. Features either a picture window or porthole, with an obstructed view, two lower beds that convert into a queen-size bed and extra bedding for two additional guests.

### I4 FAMILY INSIDE

Sleeps up to four. Featuring two lower beds that convert into a queen-size bed and extra bedding for two additional guests. Includes room service and many other amenities.

### IA IB IF INSIDE\*

Sleeps up to four. Featuring two lower beds that convert into a queen-size bed. Includes room service and many other amenities.

### IT SOLO INSIDE

These staterooms include a queen-size bed and the same amenities as other inside staterooms. Staterooms are priced exclusively for solo travelers.

# NORWEGIAN GEM SCHEMATICS

**H1** The Haven 3-Bedroom Garden Villa. Sleeps up to eight.



**H2** The Haven Deluxe Owner's Suite with Large Balcony. Sleeps up to four.



**H6** The Haven 2-Bedroom Family Villa with Balcony. Sleeps up to six.



**HF** The Haven Courtyard Penthouse with Balcony. Sleeps up to three.



**MB** Club Balcony Suite. Sleeps up to four.



**BF** Balcony. Sleeps up to four.



**OB** Oceanview. Sleeps up to four.





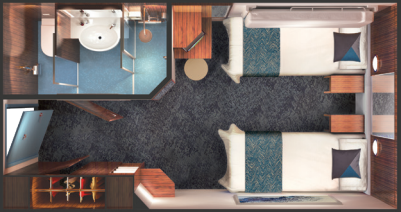





**IF** Inside. Sleeps up to four.



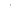

# NORWEGIAN GEM DECK PLANS

## LEGEND

-  Wheelchair Accessible
-  Connecting staterooms
-  Third-person occupancy available
-  Third- and/or fourth-person occupancy available
-  Up to sixth-person occupancy available
-  Up to eighth-person occupancy available
-  Elevator
-  Restroom
-  PrivaSea (partially enclosed) balcony

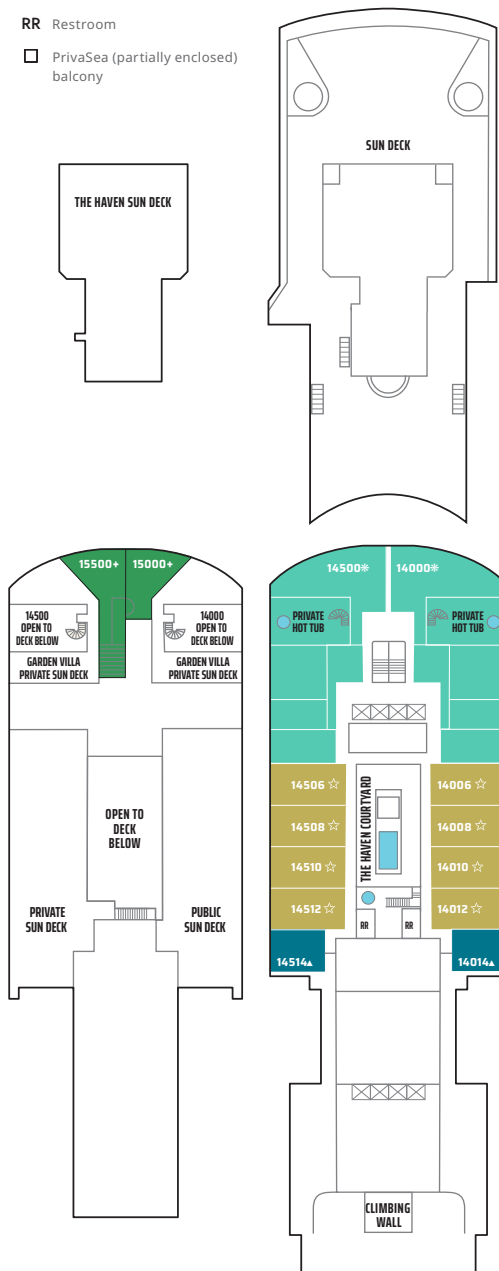

## H2

## DECK 15

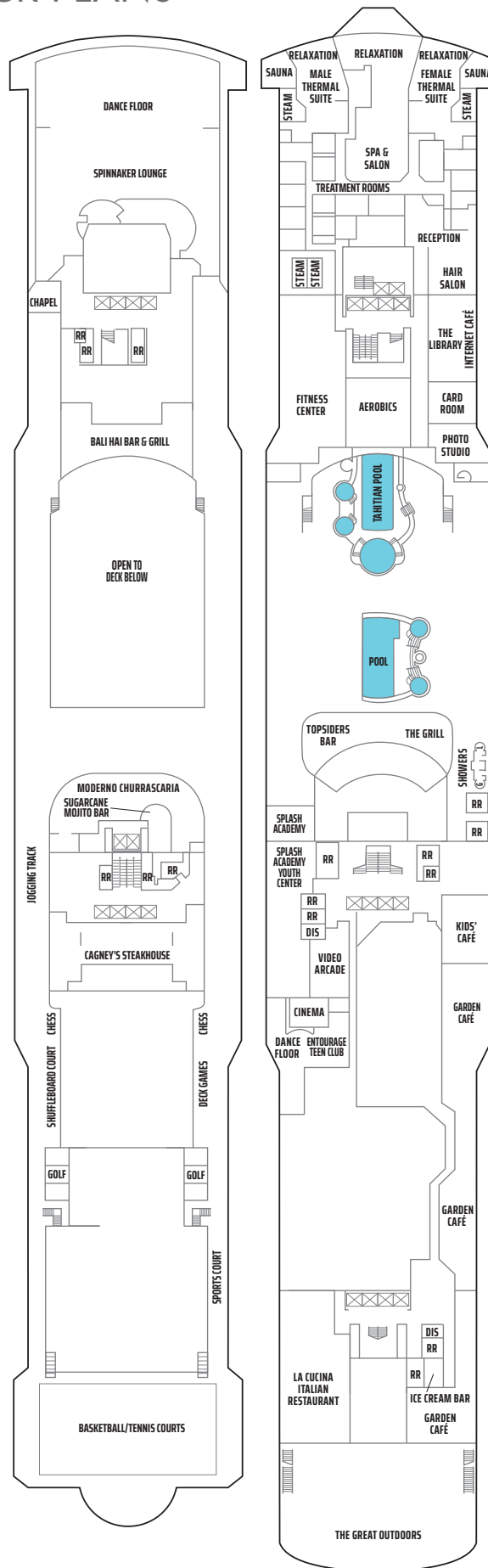

## DECK 13

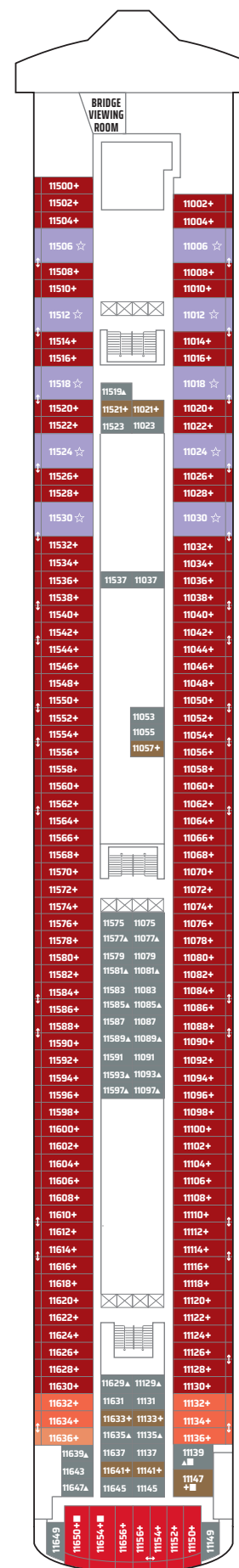

S4	M1	MA	MB
I4	IA	MX	

## DECK 11

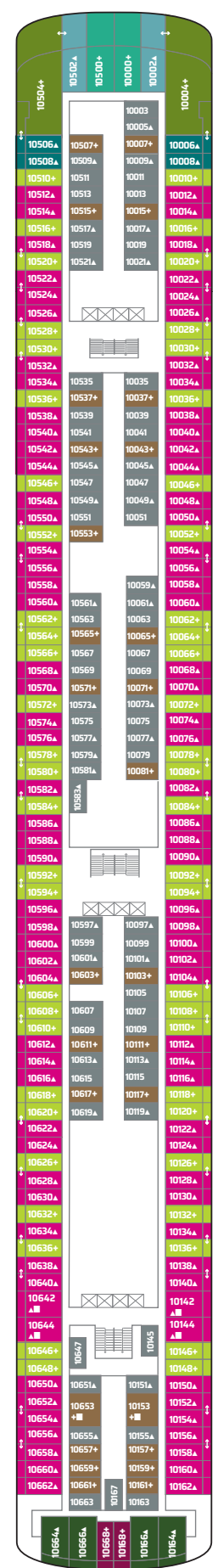

H3	SD	SF	SM	B1
B4	BA	BF	I4	IA

## DECK 10

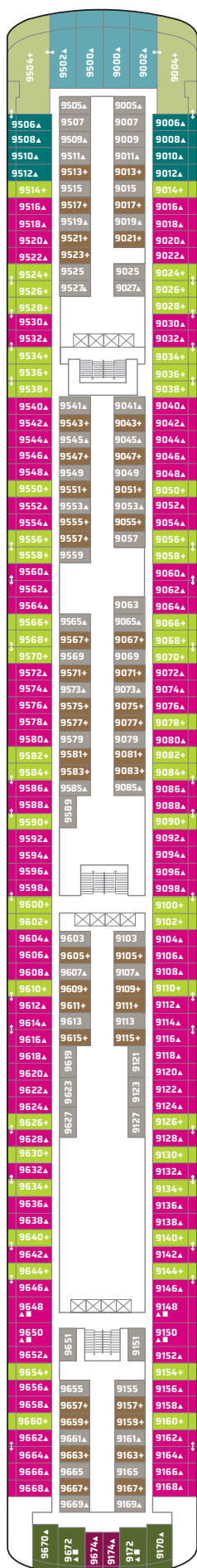

DECK 9

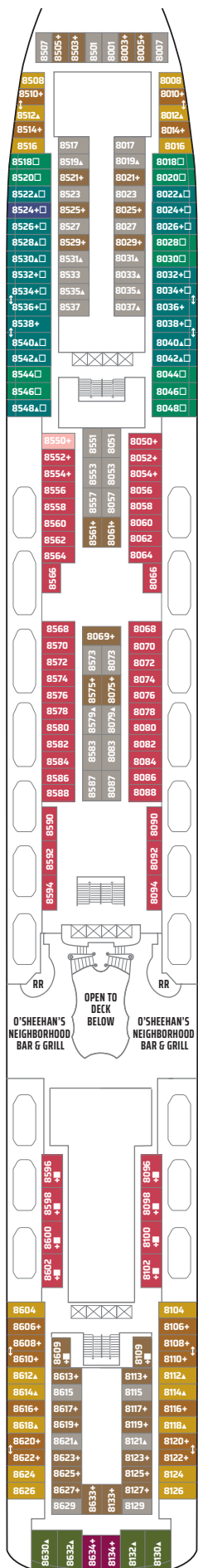

DECK 8

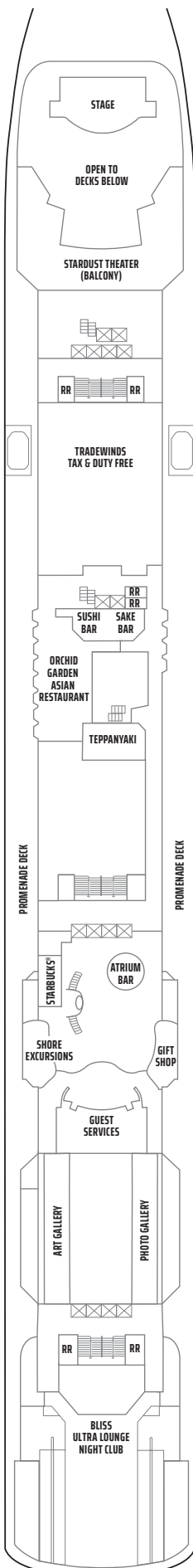

DECK 7



DECK 6

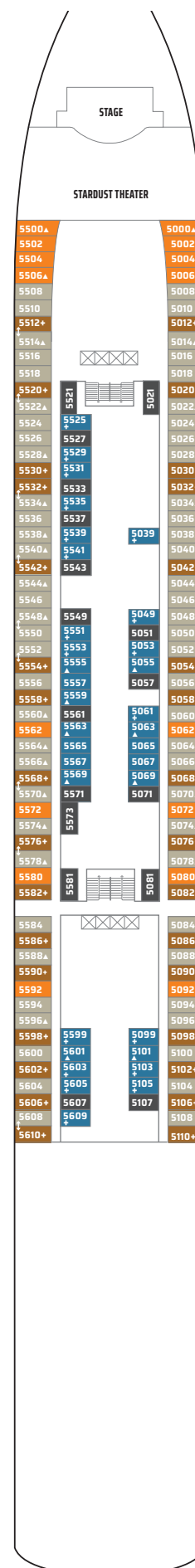

DECK 5

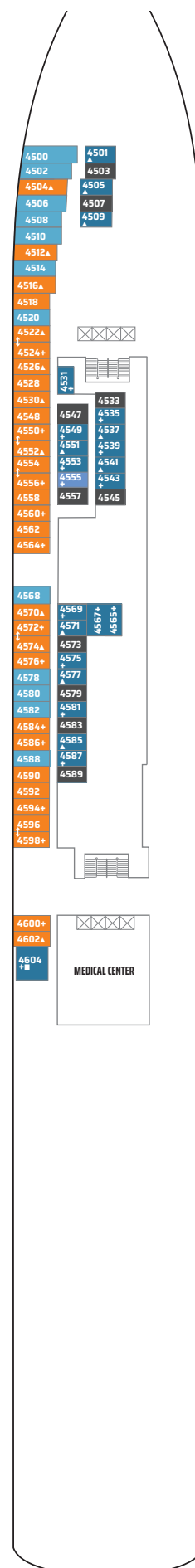

DECK 4